



32.2\*27.5\*28.5MM



32.2\*27.5\*20.5MM

# NB901



R 50193486

 CQC12002069367  
CQC12002069368

E 361440

## Product Features

- ◆ Contacts switching capability: 40A
- ◆ 2500VAC for dielectric strength between contact and coil
- ◆ Coil insulation grade Class F
- ◆ Contacts forms NO,NC&SPDT
- ◆ Dust-proof&Sealed type
- ◆ Complies with RoHS-Directive
- ◆ Dimensions: 32.2\*27.5\*28.5 mm & 32.2\*27.5\*20.5 mm

## Contact Rating

Contact Form	1A、1B、1C		
Contact Material	AgCdO AgSnO <sub>2</sub>		
Contact Load Capacity	1A	1B	1C
	NO: 40A 240VAC,30VDC 40A 277VAC,1HP 240VAC TV-5	30A 240VAC,30VDC 30A 277VAC,1HP 240VAC TV-5	40A 240VAC,30VDC 40A 277VAC,1HP 240VAC TV-5
	NC:		30A 240VAC,30VDC 30A 277VAC,1/2HP TV-5
Switching Power Max.	1200W 9600VA		
Switching Voltage Max.	30VDC/277VAC		
Switching Current Max.	1A: 40A ; 1B: 30A ; 1C: 40A		
Contact Resistance Max.	50mΩ (1A , 24VDC)		
Life expectancy	Electrical	10 <sup>5</sup>	
	Machanical	10 <sup>7</sup>	

**Coil Rating**

900mw						600mw					
No.	Coil Voltage		Coil Resistance $\Omega \pm 10\%$	Pick up (VDC) Max. (75% of Rated Voltage)	Drop out (VDC) Min.(10% of Rated Voltage)	No.	Coil Voltage		Coil Resistance $\Omega \pm 10\%$	Pick up (VDC) Max. (75% of Rated Voltage)	Drop out (VDC) Min.(10% of Rated Voltage)
	Rated	Max.					Rated	Max.			
005	5	6.5	28	3.75	0.5	003	3	3.9	15	2.25	0.3
006	6	7.8	40	4.50	0.6	005	5	6.5	42	3.75	0.5
009	9	11.7	90	6.75	0.9	006	6	7.8	60	4.50	0.6
012	12	15.6	160	9.00	1.2	009	9	11.7	135	6.75	0.9
015	15	19.5	250	10.25	1.5	012	12	15.6	240	9.00	1.2
018	18	23.4	360	13.50	1.8	015	15	19.5	375	10.25	1.5
024	24	31.2	640	18.00	2.4	018	18	23.4	540	13.50	1.8
048	48	62.4	2560	36.00	4.8	024	24	31.2	960	18.00	2.4
110	110	143	13445	82.50	11	048	48	62.4	3840	36.00	4.8

**Technical Rating**

Insulation Resistance	Min.1000M $\Omega$ (500VDC)	IEC 60255-5	
Dielectric Strength	Between Contacts	1500VAC	IEC 60255-5
	Between Coil&Contact	2500VAC , min	IEC 60255-5
Operate Time	$\leq 15\text{ms}$		
Release Time	$\leq 10\text{ms}$		
Shock Resistance	Operation extremes 10G    Damage limits 100G	IEC 68-2-27 test Ea	
Vibration Resistance	10Hz~55Hz double amplitude 1.5mm	IEC 68-2-6 test Fc	
Ambient Temperature	- 40 $^{\circ}\text{C}$ ~85 $^{\circ}\text{C}$ ; - 40 $^{\circ}\text{C}$ ~105 $^{\circ}\text{C}$		
Relative Humidity	85% RH , 40 $^{\circ}\text{C}$	IEC 68-2-3 test Ca	
Weight	Approx.30g		
Package	Sealed;Dust-proof type		

**Designation**

**NB901 - 12S - S - A**  
1            2 3    4    5

- 1、 **NB901**: Model No.(Max. contact load capacity 40A)
- 2、 **12**: Coil Rated Voltage:5V,6V,9V,12V,15V,18V,24V,48V,110V(DC)
- 3、 **S**: Package: S:Sealed D:Dust proof
- 4、 **S**: Contact Material: **S**:AgSnO<sub>2</sub> **C**:AgCdO
- 5、 **A**: Contact Form: A:Normally Open B:Normally Close C:SPDT(Normally Open&Close)

 Please specify Tall Profile or Low Profile for NB901 series relays.

**Note:**(1) Applying under clean environment(excluding H<sub>2</sub>S、 SO<sub>2</sub>、 NO<sub>2</sub>、 dust contaminants), dust-proof type is recommended;

Applying under polluted environment(containing H<sub>2</sub>S、 SO<sub>2</sub>、 NO<sub>2</sub>、 dust contaminants, sealed type is recommended, and please confirm during practical applying;

- (2) When installed on PCB,and entire washing is needed,please notice us before order, so as to provide proper items;
- (3) If dielectric strength between coil&contacts have to be over 2500VAC, please notice us before order, so as to provide proper items;
- (4) Avoid applying under strong magnetic or shock extremes,or technical rating will change.

Dimensions

Outline Dimension

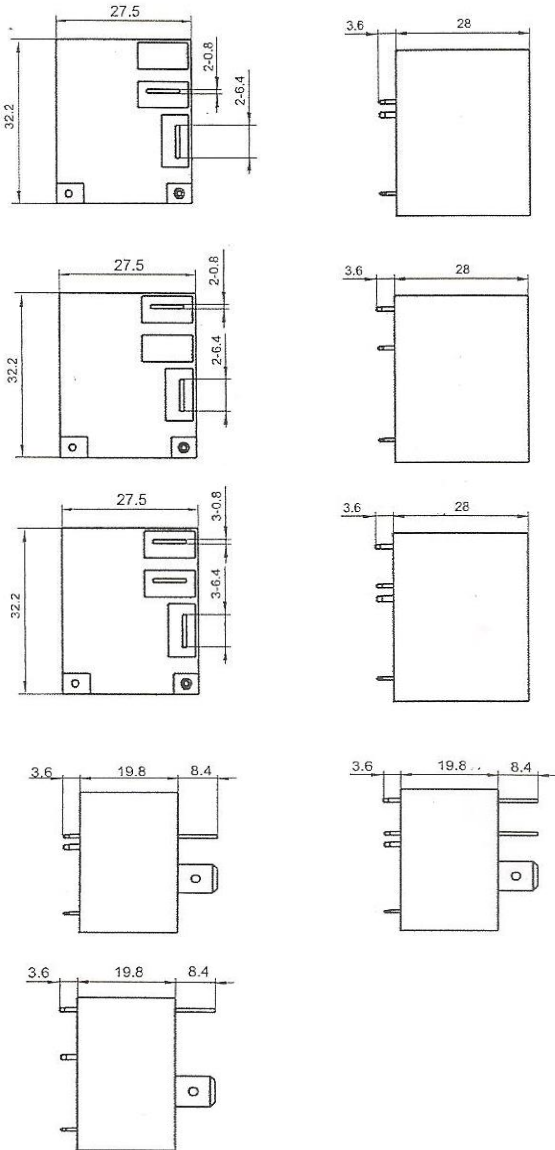

Wiring Diagram(Bottom View)

NO:

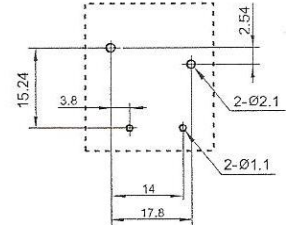
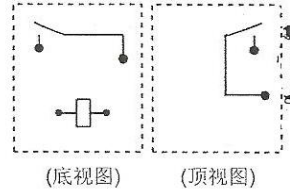

NC:

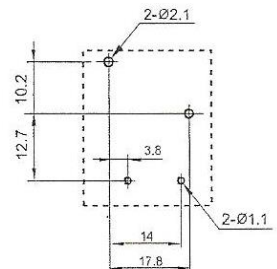
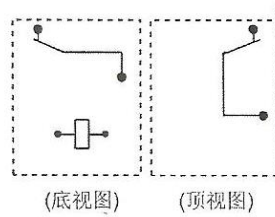

SPDT:

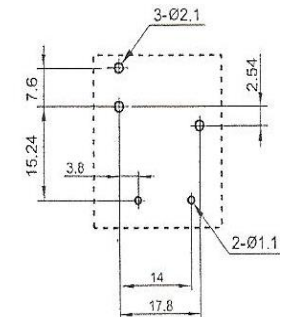
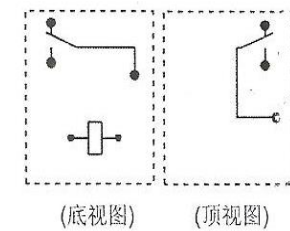

Engineering Data

